

## Fall Protection Anchorage Point PE.SEB

---

### Product information



The Fall Protection Anchorage Point is fitted with an automatic position recovery system for optimum orientation in the direction of the sling.

#### Features:

- 360° rotation.
- Control anti-crack on 100% of product.

... [Read more](#)

---

**Material:** High Tensile Alloy Steel

**Marking:** According to standard

**Temperature range:** -20°C up to + 200°C

**Finish:** Galvanized + painted yellow

**Standard:** EN 795

## Fall Protection Anchorage Point PE.SEB

### Blueprint

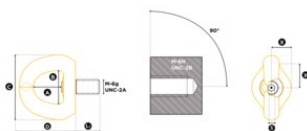

### Technical data

Part code	Max. number of persons	Thread	Torque Nm	A mm	B mm	C mm	D mm	L1mm mm	S mm	X mm mm	Weight kg
8415PESEBM12	1	M 12 (x1,75)	15	30	34	60	57	21	6	20	0.24
8415PESEBM16	1	M 16 (x2)	50	38	45	88	80	27	8	35	0.8
8415PESEBM20	1	M 20 (x2,5)	100	38	45	88	80	30	8	35	0.8