

Closed Spelter Socket Green Pin® G-6411

Product information



The Green Pin® Closed Spelter Socket is made from high tensile steel. Its long-term durability is assured due to galvanization. The Green Pin® Closed Spelter Socket is available for a diameter wire rope of 6-7 up to 120-130 mm and can be used in combination with the Socket Lock Socketing Resin.

Certification on request: 2.1, 2.2, 3.1

... [Read more](#)

Material: High Tensile Steel

Marking: CE-marked

Temperature range: -20°C up to +200°C

Finish: Hot Dipped Galvanized

Closed Spelter Socket Green Pin® G-6411

Blueprint

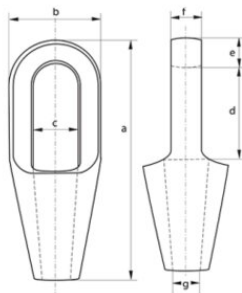

Technical data

| Part code | Rope Ø range mm | MBL ton | Finish | a mm | b mm mm | c mm | dmm mm | e mm mm | f mm mm | g mm mm | Weight kg |
|--------------|-----------------|---------|------------|-------|---------|------|--------|---------|---------|---------|-----------|
| 122100700372 | 6-7 | 8 | Galvanized | 101 | 37 | 22 | 40 | 11 | 13 | 9 | 0.26 |
| 122101000372 | 8-10 | 12 | Galvanized | 119 | 43 | 25 | 48 | 14 | 17.5 | 12 | 0.5 |
| 122101300372 | 11-13 | 20 | Galvanized | 140 | 52 | 30 | 58 | 18 | 23.5 | 15 | 0.72 |
| 122101600372 | 14-16 | 25 | Galvanized | 162 | 68 | 37 | 66 | 21 | 26 | 17.5 | 1.47 |
| 122101900372 | 18-19 | 45 | Galvanized | 194 | 76 | 42 | 78 | 27 | 32 | 21.5 | 2.24 |
| 122102200372 | 20-22 | 70 | Galvanized | 224 | 92 | 47 | 90 | 33 | 38 | 24 | 4.2 |
| 122102600372 | 23-26 | 85 | Galvanized | 253 | 104 | 57 | 103 | 36 | 44 | 28 | 6.03 |
| 122103000372 | 27-30 | 105 | Galvanized | 282 | 114 | 63 | 116 | 39 | 51 | 32 | 7.85 |
| 122103600372 | 31-36 | 136 | Galvanized | 312 | 127 | 70 | 130 | 43 | 57 | 38 | 10.8 |
| 122103900372 | 37-39 | 150 | Galvanized | 358 | 136 | 79 | 155 | 51 | 63 | 41 | 13.6 |
| 122104200372 | 40-42 | 170 | Galvanized | 390 | 146 | 83 | 171 | 54 | 70 | 44 | 17 |
| 122104800372 | 43-48 | 225 | Galvanized | 443 | 171 | 93 | 198 | 55 | 76 | 51 | 26 |
| 122105400372 | 49-54 | 280 | Galvanized | 502 | 193 | 100 | 224 | 62 | 82 | 57 | 37.5 |
| 122106000372 | 55-60 | 360 | Galvanized | 548 | 216 | 112 | 247 | 73 | 92 | 63 | 54.5 |
| 122106800372 | 61-68 | 425 | Galvanized | 597 | 241 | 140 | 270 | 79 | 102 | 73 | 69.5 |
| 122107500372 | 69-75 | 460 | Galvanized | 644 | 273 | 159 | 286 | 79 | 124 | 79 | 100 |
| 122108000372 | 76-80 | 560 | Galvanized | 686 | 292 | 171 | 298 | 83 | 133 | 86 | 121 |
| 122108600372 | 81-86 | 625 | Galvanized | 743 | 311 | 184 | 311 | 102 | 146 | 92 | 156 |
| 122109300372 | 87-93 | 720 | Galvanized | 788 | 330 | 197 | 330 | 102 | 159 | 99 | 181 |
| 122110200372 | 94-102 | 875 | Galvanized | 845 | 362 | 216 | 356 | 108 | 178 | 108 | 210 |
| 122111500372 | 108-115 | 1,200 | Galvanized | 1,000 | 405 | 235 | 425 | 125 | 190 | 125 | 334 |
| 122113000372 | 120-130 | 1,300 | Galvanized | 1,150 | 450 | 260 | 525 | 125 | 200 | 143 | 500 |

Closed Spelter Socket Green Pin® G-6411
