

Eyebolts - Collared BS 4278:1984 (Metric Thread)

Product information

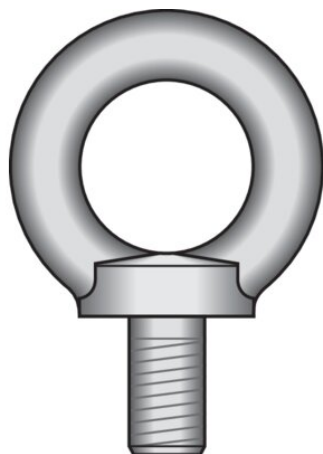

Sizes marked * are additional and proportional to the specification.
Also available with UNC, UNF, BSF threads.
The zinc plated on request.

[... Read more](#)

Finish: Self Colour

Warning: Safe working loads quoted refer to the load being applied vertically.
Eyebolts need to be down rated when side loading occurs.

Eyebolts - Collared BS 4278:1984 (Metric Thread)

Blueprint

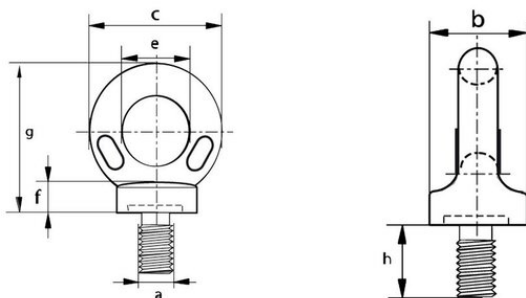

Technical data

Part code	WLL ton	Thread mm	a mm	b mm mm	c mm	e mm mm	f mm mm	g mm mm	h mm mm	Weight kg
421100010052	0.1	6*	6	22	33	15	7	36	18	0.06
421100020050	0.15	8*	8	22	33	15	7	36	18	0.06
421100030050	0.25	10*	10	22	33	15	7	36	18	0.06
421100040050	0.4	12	12	22	33	15	7	36	18	0.06
421100050050	0.5	14*	14	29	44	20	10	48	23	0.15
421100080050	0.8	16	16	29	44	20	10	48	23	0.15
421100100050	1	18*	18	36	52	24	12	58	28	0.27
421100160050	1.6	20	20	40	59	27	14	65	32	0.38
421100160055	1.6	22*	22	45	64	30	14	73	35	0.54
421100250055	2.5	24	24	52	77	35	17	84	40	0.85
421100250050	2.5	27*	27	58	85	39	20	94	46	1.13
421100400050	4	30	30	65	96	44	22	106	51	1.62
421100400055	4	33*	33	72	106	48	24	117	56	2.37
421100630050	6.3	36	36	81	118	54	27	131	63	3.12
421100630055	6.3	39*	39	86	123	57	29	137	67	3.12
421100800050	8	42	42	101	148	68	34	164	79	6.45
421100800055	8	45*	45	101	148	68	34	164	79	6.45
421101000050	10	48	48	101	148	68	34	164	79	6.51
421101250050	12.5	52	52	115	168	76	38	186	89	9.58
421101600050	16	56	56	128	188	86	43	208	100	12.99
421102000050	20	64	64	144	212	96	48	234	112	18.2