

## Heavy Duty Bow Shackle BN Green Pin® P-6036

### Product information

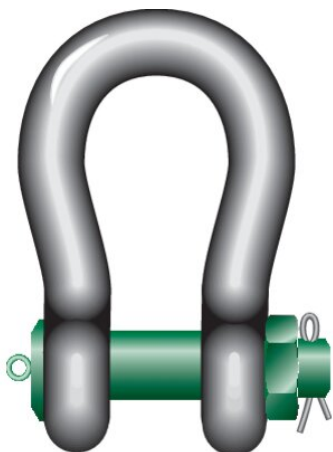

The Green Pin® Heavy Duty Bow Shackle BN is a high load capacity bow shackle with a safety bolt. The Green Pin® Heavy Duty Bow Shackle BN is a good choice for heavy lifting projects and is suitable for both one-leg en multi-leg systems. When rotation of the pin is a risk, this shackle's safety bolt prevents accidental unscrewing. Another important feature of the product is that the Green Pin® Heavy Duty Bow Shackle BN conforms to a wide range of certifications. For example, Heavy Duty Shackles of 150T and higher include a Lloyd's proofload test certificate. The Green Pin® Heavy Duty Bow Shackle BN is available in a range with a working load limit from 120 up to 1500 ton.

Certification on request: 2.1, 2.2, 3.1, MTCa, MTCb, LROS, MPIa, USA [... Read more](#)

**Material:** Bow and pin alloy steel, quenched and tempered.

**Marking:** CE-marked

**Finish:** Shackle bow painted silver, pin painted green

**Note:** This shackle can also be delivered with fixed nut (an extra AISI 316 securing bolt is drilled through both the nut and shackle pin. This securing bolt is fastened with two sets of Nord-Lock®)

**Safety factor:** 5:1

**Grade:** 8

## Heavy Duty Bow Shackle BN Green Pin® P-6036

### Blueprint

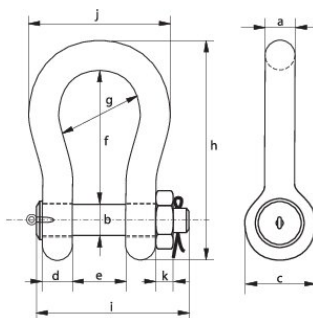

### Technical data

Part code	WLL ton	A mm	B mm	C mm	D, mm	e mm mm	f mm mm	g mm mm	h mm mm	i mm mm	j mm mm	k mm mm	Weight kg
420112000970	120	95	95	208	95	147	400	238	647	453	428	50	110
420115000970	150	105	108	238	105	169	410	275	688	496	485	50	160
420120000970	200	120	130	279	120	179	513	290	838	564	530	70	235
420125000970	250	130	140	299	130	205	554	305	904	614	565	70	295
420130000970	300	140	150	325	140	205	618	305	996	644	585	80	368
420140000970	400	170	175	376	164	231	668	325	1,114	690	665	70	560
420150000970	500	180	185	398	164	256	718	350	1,190	720	710	70	685
420160000970	600	200	205	444	189	282	718	375	1,243	810	775	70	880
420170000970	700	210	215	454	204	308	718	400	1,263	870	820	70	980
420180000970	800	210	220	464	204	308	718	400	1,270	870	820	70	1,100
420190000970	900	220	230	485	215	328	718	420	1,296	920	860	70	1,280
420110000971	1,000	240	240	515	215	349	718	420	1,336	940	900	70	1,460
420112500971	1,250	260	270	585	230	369	768	450	1,456	1,025	970	70	1,990
420115000971	1,500	280	290	625	230	369	818	450	1,556	1,025	1,010	70	2,400