

Closed Spelter Socket

Product information



The closed spelter socket from the standard series has a wide range of applications as a steel wire rope socket for general use in any situation and under various conditions. If the minimum breaking load of the wire is not higher than that of the closed spelter socket, a 100% breaking load of the socket-wire combination is guaranteed. Non-standard sizes or custom products available on request. ISO 3189.

Working Load Limit: 20% of the MBL

Standard certification: Certificate of Conformity, 3.1 material Certificate EN 10204
... [Read more](#)

Material: Cast steel

Temperature range: -40 up to +200 degrees Celsius

Finish: Painted or galvanized

Closed Spelter Socket

Blueprint

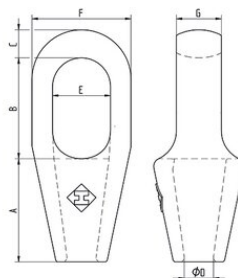

Technical data

Part code	Code	Rope Ø range mm	MBL	Finish	Rope Ø inch	A mm	B mm	C mm	D, mm	E mm	F mm	G, mm	Weight kg
122100700332	290	6-7	8	Galvanized	1/4	52	46	11	8	20	36,5	13	0.3
122100700335	290	6-7	8	Painted	1/4	52	46	11	8	20	36.5	13	0.3
122101000332	292	8-10	12	Galvanized	5/16 - 3/8	58	52,5	14	11	24	43	16	0.4
122101000335	292	8-10	12	Painted	5/16-3/8	58	52,5	14	11	24	43	16	0.4
122101300332	294	11-13	20	Galvanized	7/16 - 1/2	63,5	59	17,5	14	28,5	51	22	0.8
122101300335	294	11-13	20	Painted	7/16 - 1/2	63.5	59	17.5	14	28.5	51	22	0.8
122101600332	296	14-16	30	Galvanized	9/16 - 5/8	76,5	65	20,5	17,5	35	66,5	25,4	1.4
122101600335	296	14-16	30	Painted	9/16 - 5/8	76.5	65	20.5	17.5	35	66.5	25.4	1.4
122101900332	298	18-19	40	Galvanized	3/4	90	75	26	21	42	75	31	2.1
122101900335	298	18-19	40	Painted	3/4	90	75	26	21	42	75	31	2.1
122102200332	201	20-22	60	Galvanized	7/8	101	90	33	24	47	92	38	4
122102200335	201	20-22	60	Painted	7/8	101	90	33	24	47	92	38	4
122102600332	204	23-26	75	Galvanized	1	114	103	36	28	57	106	45	6
122102600335	204	23-26	75	Painted	1	114	103	36	28	57	106	45	6
122103000332	207	27-30	100	Galvanized	1 1/8	127	116	39	32	63	114	51	7.5
122103000335	207	27-30	100	Painted	1 1/8	127	116	39	32	63	114	51	7.5
122103600332	212	31-36	125	Galvanized	1 1/4 - 1 3/8	139	130	44	38	70	128	58	11
122103600335	212	31-36	125	Painted	1 1/4 - 1 3/8	139	130	44	38	70	128	58	11
122103900332	215	37-39	150	Galvanized	1 1/2	152	155	51	41	79	137	64	14
122103900335	215	37-39	150	Painted	1 1/2	152	155	51	41	79	137	64	14
122104200332	217	40-42	180	Galvanized	1 5/8	165	171	54	44	82	146	70	17.5
122104200335	217	40-42	180	Painted	1 5/8	165	171	54	44	82	146	70	17.5

Closed Spelter Socket

Technical data

Part code	Code	Rope Ø range mm	MBL	Finish	Rope Ø inch	A mm	B mm	C mm	D, mm	E mm	F mm	G, mm	Weight kg
122104800332	219	43-48	230	Galvanized	1 3/4 - 1 7/8	190	198	56	51	89	171	77	27.5
122104800335	219	43-48	230	Painted	1 3/4 - 1 7/8	190	198	56	51	89	171	77	27.5
122105400332	222	49-54	280	Galvanized	2 - 2 1/8	216	224	62	57	98	194	84	40
122105400335	222	49-54	280	Painted	2 - 2 1/8	216	224	62	57	98	194	84	40
122106000332	224	55-60	375	Galvanized	2 1/4 - 2 3/8	228	247	73	65	110	216	94	52
122106000335	224	55-60	375	Painted	2 1/4 - 2 3/8	228	247	73	65	110	216	94	52
122106800332	226	61-68	425	Galvanized	2 1/2 - 2 5/8	248	270	80	73	140	241	102	63
122106800335	226	61-68	425	Painted	2 1/2 - 2 5/8	248	270	80	73	140	241	102	63
122107500332	227	69-75	500	Galvanized	2 3/4 - 2 7/8	279	286	79	79	159	273	124	88.5
122107500335	227	69-75	500	Painted	2 3/4 - 2 7/8	279	286	79	79	159	273	124	88.5
122108000332	228	76-80	600	Galvanized	3 - 3 1/8	305	298	83	86	171	292	133	111
122108000335	228	76-80	600	Painted	3 - 3 1/8	305	298	83	86	171	292	133	111
122108600332	229	81-86	700	Galvanized	3 1/4 - 3 3/8	330	311	102	92	184	311	146	143
122108600335	229	81-86	700	Painted	3 1/4 - 3 3/8	330	311	102	92	184	311	146	143
122109300332	230	87-93	750	Galvanized	3 1/2 - 3 5/8	356	330	102	99	197	330	159	166
122109300335	230	87-93	750	Painted	3 1/2 - 3 5/8	356	330	102	99	197	330	159	166
122110200332	231	94-102	950	Galvanized	3 3/4 - 4	381	356	108	108	216	362	178	217
122110200335	231	94-102	950	Painted	3 3/4 - 4	381	356	108	108	216	362	178	217
122111500332	233	108-115	1,200	Galvanized	4 1/2	460	425	120	125	235	405	190	338
122111500335	233	108-115	1,200	Painted	4 1/2	460	425	120	125	235	405	190	338
122113000332	240	122-130	1,400	Galvanized	5	500	475	140	138	270	515	210	579
122113000335	240	122-130	1,400	Painted	5	500	475	140	138	270	515	210	579
122115500332	250	140-155	2,000	Galvanized	5 1/2 - 6	580	550	150	160	300	510	250	654
122115500335	250	140-155	2,000	Painted	5 1/2 - 6	580	550	150	160	300	510	250	654
122116700332	260	158-167	2,500	Galvanized	6 1/2	675	600	175	175	325	600	300	1,063
122116700335	260	158-167	2,500	Painted	6 1/2	675	600	175	175	325	600	300	1,063