

## GN BL3 Snatch Block for Shackle Lifting

---

### Product information

For Shackle Lifting. Sheave with bronze bearing.

[... Read more](#)

---



**Material:** Mild steel

**Temperature range:** -20°C up to 200°C

**Finish:** Painted

**Safety factor:** 4:1

## GN BL3 Snatch Block for Shackle Lifting

Blueprint

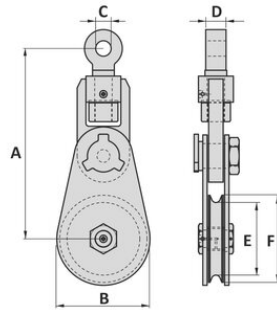

## GN BL3 Snatch Block for Shackle Lifting

### Technical data

Part code	Rope Ø range mm	WLL ton	Model	Type	WLL line pull ton	A mm	B mm	C mm	D mm	E mm	F mm	Weight kg
424100330150	8-10	3.25	Light Type	H41903	1.62	188	82	20	26	56	76	4
424100480150	11-14	4.75	Light Type	H41905	2.37	250	122	24	30	86	114	9
424100850150	18-20	8.5	Light Type	H41906	4.25	356	162	30	40	112	152	19
424100850155	18-20	8.5	Light Type	H41908	4.25	381	216	30	40	163	203	24
424100950150	18-20	9.5	Light Type	H41910	4.75	406	270	34	44	214	254	30
424100950155	18-20	9.5	Light Type	H41912	4.75	446	320	34	44	265	305	39
424101200150	18-20	12	Light Type	H41914	6	516	396	37	48	315	365	50
424101350150	22-25	13.5	Light Type	H41916	6.75	645	430	42	54	356	406	93
424101700155	22-25	17	Heavy Type	H43106	8.5	490	160	44	57	110	150	49
424101700150	22-25	17	Light Type	H41918	8.5	690	490	44	57	408	458	112
424102500157	25-28	25	Heavy Type	H43108	12.5	602	220	53	70	150	200	78
424102500155	28-32	25	Heavy Type	H43110	12.5	632	270	53	70	190	250	92
424102500156	28-32	25	Heavy Type	H43112	12.5	662	320	53	70	240	300	112
424102500150	28-32	25	Heavy Type	H43114	12.5	692	370	53	70	290	350	127
424103500150	32-38	35	Heavy Type	H43118	17.5	835	470	60	80	380	450	213
424103500155	32-38	35	Heavy Type	H43120	17.5	865	520	60	80	430	500	243
424103500156	32-38	35	Heavy Type	H43124	17.5	925	625	60	80	535	605	308
424105500150	38-42	55	Heavy Type	H43224	27.5	1,040	625	73	100	520	605	449
424108500150	44-48	85	Heavy Type	H43230	42.5	1,212	780	85	120	630	750	938
424112000150	50-55	120	Heavy Type	H43234	60	1,327	880	100	140	740	860	1,319
424115000150	60-70	150	Heavy Type	H43236	75	1,427	930	113	160	760	910	1,600
424120000150	75-85	200	Heavy Type	H43242	100	1,630	1,080	135	170	870	1,060	2,285
424125000150	88-93	250	Heavy Type	H43246	125	1,785	1,190	145	190	970	1,170	3,015