

Lifting Point RUD B-ABA

Product information



The RUD B-ABA ring is a lifting point designed for handling heavy loads in all loading directions.

Product features:

- 100% of the WLL in all directions, without any reduction
- No rattling or play, even under strong vibrations or shock loads
- Wear indicators on the inside and outside of the body

... [Read more](#)

Marking: According to standard

Temperature range: -40°C up to +100°C.

Standard: EN 1677-1, EN ISO 12100

Safety factor: 4:1

Lifting Point RUD B-ABA

Blueprint

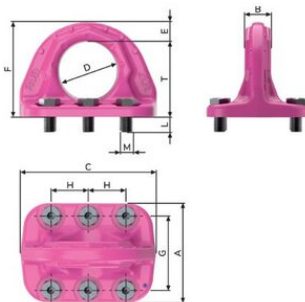

Technical data

Part code	WLL ton	A mm	B mm	C mm	D, mm	E mm	F mm	G, mm	H, mm	L mm	Mmm mm	T mm	Weight kg
42157906266	1.6	75	16	100	35	16	62,5	55	55	13	M10	47	0.88
42157906267	3.2	92	23	137	50	21	86	70	75	16	M12	65	2.01
42157906268	5	113	27	172	60	28	108	84	95	24	M16	80	4.07
42157906269	10	146	38	228	80	36	141	110	125	25	M20	105	9.31
42157906270	20	200	52	272	115	40	188	150	75	30	M24	148	18.77
42157906271	31.5	230	64	320	130	50	220	175	87.5	40	M30	170	29.5