

## Connection link for Pennant Lines SC2 GN

---

### Product information

We deliver quality connection link for Pennant Lines SC2 GN in forged <sup>alloy steel</sup> [... Read more](#)

---



**Material:** Forged alloy steel.

**Finish:** Painted.

**Safety factor:** 5:1

## Connection link for Pennant Lines SC2 GN

### Blueprint

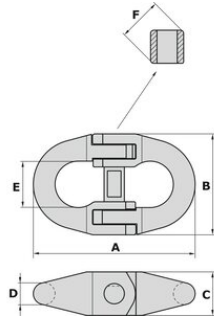

### Technical data

Part code	WLL ton	A mm	B mm	C mm	D mm	E mm	F mm	Weight kg
400211000010	110	560	360	108	76	156	150	76