

Super Bow Shackles with Safety Bolt and Fixed Nut G-5243

Product information



The Green Pin Super[®] Bow Shackle FN is a grade 8 bow shackle with a safety bolt and a fixed nut. Handling of the Green Pin Super[®] Bow Shackle FN is easier due to the smaller size and weight (with equal WLL compared to non-Super products). The shackle is the perfect choice when the load is dynamic or exposed to extreme vibrations because of its triple safety (split pin, safety bolt and fixed nut). The fixed nut of the Green Pin Super[®] Bow Shackle FN is drilled through both the shackle nut and pin and is firmly attached to the pin head with bolts and Nord-Lock[®] washers. Furthermore, the long-term durability of the shackle is assured as a result of its galvanization. Wear and tear of the counter components such as wire rope is also minimized as the chamber in the shackle eye hides the screw thread. The Green Pin Super[®] Bow Shackle FN is available in a range with a working load limit from 3.3 to 175 ton.

Certification on request: 2.1, 2.2, 3.1, MTCa, MTCb, LROS

[... Read more](#)

Material: Bow and pin alloy steel, quenched and tempered

Marking: CE-marked

Temperature range: -20°C up to +200°C

Finish: Hot dipped galvanized (150 ton and upward are painted)

Safety factor: 5:1

Grade: 8

Super Bow Shackles with Safety Bolt and Fixed Nut G-5243

Blueprint

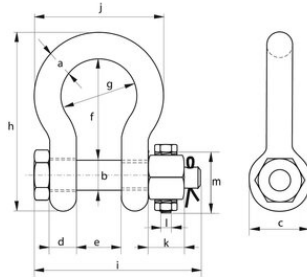

Technical data

Part code	WLL ton	Torque Nm	a mm	b mm	c mm	d mm	e mm	f mm	g mm	h mm	i mm	j mm	k mm	l mm	m mm	Weight kg
420100330710	3.3	8.4	13.5	16	34	13	22	51	32	89	82	58	13	M6	35	0.4
420100500710	5	8.4	16	19	40	16	27	64	43	110	98	75	17	M6	40	0.73
420100700710	7	8.4	19	22	46	19	31	76	51	129	114	89	19	M6	45	1.19
420100950710	9.5	20	22	25	52	22	36	83	58	144	130	102	22	M8	50	1.73
420101250710	12.5	20	25	28	59	25	43	95	68	164	150	118	25	M8	55	2.56
420101500710	15	39	28	32	66	28	47	108	75	185	166	131	27	M10	60	3.6
420101800710	18	39	32	35	72	32	51	115	83	201	178	147	30	M10	65	4.95
420102100710	21	39	35	38	80	35	57	133	92	227	197	162	33	M10	70	6.62
420103000710	30	20	38	42	88	38	60	146	99	249	217	175	34	M8	75	8.11
420104000710	40	20	45	50	103	45	74	178	126	300	260	216	40	M8	90	15
420105500710	55	39	57	57	117	57	83	197	138	341	303	252	46	M10	100	23
420108500710	85	68	70	70	143	70	105	260	180	437	363	320	56	M12	120	44
420112000710	120	68	83	83	162	83	127	329	190	535	425	356	66	M12	140	72
420115000710	150	68	95	95	208	95	147	400	238	647	524	428	50	M12	150	112
420117500710	175	68	105	108	238	105	169	410	275	688	567	485	50	M12	160	160