

## Alloy Pear Shaped Links Crosby A-341

---

### Product information

Individually Proof Tested at 2 times Working Load Limit with certification.

... [Read more](#)



---

**Material:** Alloy steel — Quenched & Tempered.

**Safety factor:** 5:1

## Alloy Pear Shaped Links Crosby A-341

### Blueprint

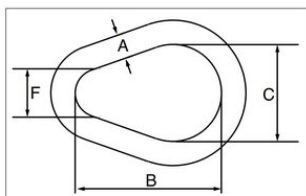

### Technical data

Part code	Chain diameter mm	WLL ton	A mm	B mm	C mm	F mm	Weight kg
40981013575	13	3.15	13	76.2	50.8	25.4	0.25
40981013584	16	4.09	16	95.3	63.5	31.8	0.5
40981013595	19	5.59	19	114	76.2	38.1	0.8
40981013604	22	6.81	22	133	88.9	44.5	1.28
40981013613	25	11	25	152	102	51	1.91
40981013622	28	13.9	28	171	114	57	2.83
40981013631	32	16.4	32	191	127	63.5	3.74
40981013640	35	19.5	35	210	140	70	5.1
40981013654	38	24.7	38	229	152	76	6.46
40981013672	44	38.6	44	267	178	89	10.2
40981013690	51	46.6	51	305	203	102	15.4