

## Clevis Sling Hook Crosby L-1339

### Product information



**Crosby**<sup>®</sup>

- Individually Proof Tested to 2-1/2 times the Working Load Limit with certification
- Hoist hooks incorporate two types of strategically placed markings forged into the product which address two (2) QUIC-CHECK<sup>®</sup> features: Deformation Indicators and Angle Indicators.
- Low profile hook tip
- New integrated latch (S-4320/S-4339) meets the world standard for lifting.
- Heavy duty stamped latch interlocks with the hook tip.
- High cycle, long life spring.
- When secured with the proper cotter pin through the hole in the tip of hook, meets the intent of OSHA Rule 1926.1431(g) and 1926.1501(g) for personnel lifting.
- Suitable for use with Grade 100 and Grade 80 chain.
- Fatigue rated at 1-1/2 times the Working Load Limit at 20,000 cycles

... [Read more](#)

**Material:** Forged Alloy Steel - Quenched and Tempered

**Safety factor:** 4:1

**Grade:** 10

## Clevis Sling Hook Crosby L-1339

### Blueprint

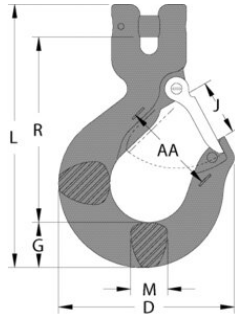

### Technical data

Part code	Chain diameter mm	WLL ton	D mm	G mm	J mm	L mm	M mm	R mm	AA mm	Weight kg
402300151530	6	1.5	72.6	18.5	23.6	107	16	74.9	38.1	0.29
402300201530	7	2	98	26.4	30.2	144	19.1	101	50.8	0.72
402300261530	8	2.6	98	26.4	30.2	144	19.1	100	50.8	0.71
402300401530	10	4	111	30.2	38.9	171	25.4	120	63.5	1.17
402300681530	13	6.8	142	36.6	45.2	213	29.7	150	76.2	2.39
402301031530	16	10.3	172	48	61.2	259	36.6	177	102	4.45
402301601530	18-20	16	211	71.9	68.3	332	50	203	114	8.3
402302101530	22-23	21	233	78	77.5	355	50	223	127	11.2