

Swivel self locking hooks 8-027

Product information



This hook is positioning device and is not intended to rotate under load. Fatigue rated to 20,000 cycles at 1.5 times the WLL. Proof Load tested at 2.5 times the WLL with certification for each batch manufactured. Magnaflux crack detection is performed 100% on each batch. With Brass Bushing.

[... Read more](#)

Material: Quenched and Tempered Alloy Steel

Marking: According to standard, Size, grade, manufacturer ID, traceability.

Temperature range: -40°C up to +200°C (without reduction in WLL).

Finish: Red painted

Standard: EN 1677-3

Safety factor: 4:1

Grade: 8

Swivel self locking hooks 8-027

Blueprint

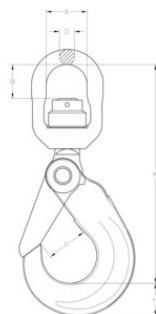

Technical data

Part code	Chain diameter mm	WLL ton	A mm	B mm	D, mm	H, mm	K mm	Pmm mm	T mm	Weight kg
420500110900	6	1.12	31	22	12	19	149	29	15	0.7
420500200900	7-8	2	36	29	14	24	186	34	20	1.2
420500320900	10	3.15	40	34	16	30	220	44	26	2
420500530900	13	5.3	46	43	22	39	267	52	30	4.2
420500800900	16	8	60	50	24	49	328	60	36	7.3
420501250900	18-20	12.5	75	82	26	62	388	90	48	11.7
420501500900	22	15	97	95	33	63	457	80	49	18
420502120900	26	21.2	123	115	52	69	535	99	56	32