

Snatch Block McKissick 431 with Shackle - Super Champion

Product information



The McKissick snatch block 431 Super Champion from Crosby is a snatch block fitted with a shackle. Available from 20 up to 30 T. Can be delivered with bronze bushing (BB) and with roller bearing (RB).

Features:

- Bolt for opening feature is retained, to ensure no lost bolts.
- Opening feature permits easy insertion of rope without reeving, or while the block is suspended.
- Center pin equipped with pressure lube fitting.
- All sizes feature sheave grooves suited for a range of wire line diameters.
- Meets or exceeds all requirements of ASME B30.26 including identification ductility, design factor, proof load and temperature requirements.
- Meet other critical performance requirements including fatigue life and material traceability, not addressed by ASME B30.26.

[... Read more](#)

Material: Forged steel.

Marking: CE-marked

Safety factor: 4:1

Snatch Block McKissick 431 with Shackle - Super Champion

Blueprint

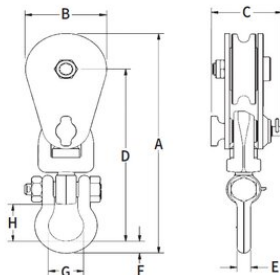

Technical data

Part code	Code	Rope Ø range mm	WLL ton	Sheave dia mm	Bearing	A mm	B mm	C mm	D mm	E mm	F mm	G mm	H mm	Weight kg
424102000420	431	26-29	20	203	BB	675	206	152	502	51	70	94	101	41.7
424102000425	431	26-29	20	203	RB	675	206	152	502	51	70	94	101	41.7
424102000426	431	26-29	20	254	BB	727	257	152	526	51	70	94	102	50.8
424102000427	431	26-29	20	254	RB	727	257	152	526	51	70	94	102	50.8
424102000428	431	26-29	20	305	BB	779	311	152	553	51	70	94	102	59
424102000429	431	26-29	20	305	RB	779	311	152	553	51	70	94	102	59
4241020004210	431	26-29	20	356	BB	838	356	152	591	51	70	94	102	72.6
4241020004211	431	26-29	20	356	RB	838	356	152	591	51	70	94	102	72.6
424102500420	431	26-32	25	457	BB	1,051	464	181	740	51	79	89	122	122.5
424102500425	431	26-32	25	457	RB	1,051	464	181	740	51	79	89	122	127
424103000425	431	26-32	30	508	RB	1,331	514	211	874	64	100	143	179	220
424103000420	431	26-32	30	508	BB	1,331	514	211	974	64	100	143	179	228.2
424103000427	431	26-32	30	610	RB	1,422	616	211	1,016	64	100	143	179	260.8
424103000426	431	26-32	30	610	BB	1,422	616	211	1,016	64	100	143	179	263.5