

Omega Link Green Pin® CO

Product information



The Green Pin® Omega Link is used to make an easy and safe connection between the chain and any other components. The Green Pin® Omega Link EN1677-1 is available in a range to suit 5 mm up to 18/20 mm grade 8 chain.

Certification on request: 2.1, 2.2, 3.1, MTCa, MPIb, DGUV

... [Read more](#)

Material: Alloy steel

Marking: According to standard

Temperature range: -40°C up to +200°C

Finish: Painted white

Standard: EN 1677-1

Safety factor: 4:1

Grade: 8

Omega Link Green Pin® CO

Blueprint

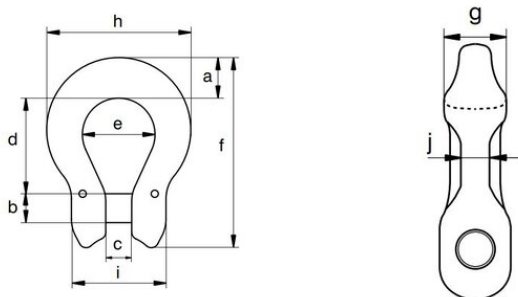

Technical data

Part code	Chain diameter mm	WLL ton	a mm	b mm mm	c mm	d mm mm	e mm mm	f mm mm	g mm mm	h mm mm	i mm mm	j mm mm	Weight kg
401200110230	6	1.12	14	8	7	25	20	53	13	41	28	6	0.07
401200200230	7-8	2	20	9	9	34	24	71	16	55	32	9	0.2
401200320230	10	3.2	19	13	12	40	31	82	17	63	42	11	0.28
401200540230	13	5.4	25	16	15	51	40	106	20	84	54	14	0.64
401200820230	16	8.2	32	20	19	64	48	132	25	104	68	17	1.28
401201280230	18-20	12.8	38	24	23	80	59	163	30	126	82	22	2.25