

Omega Link Green Pin® UCO

Product information



The Green Pin® Omega Link is a grade 10 omega link. The omega link is used to make an easy and safe connection between the chain and any other components. The Green Pin® Omega Link is available in a range to suit 6 mm up to 16 mm grade 10 chain.

Certification on request: 2.1, 2.2, 3.1, MTCa, MPIb, DGUV

... [Read more](#)

Material: alloy steel, quenched and tempered

Temperature range: -40°C up to +200°C

Finish: painted blue

Safety factor: 4:1

Grade: 10

Omega Link Green Pin® UCO

Blueprint

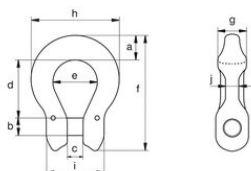

Technical data

Part code	WLL ton	For chain Ø mm	a mm	b mm	c mm	d mm	e mm	f mm	g mm	h mm	i mm	j mm	Weight kg
402200140180	1.4	6	14	8	7	25	20	53	13	41	28	6	0.07
402200200180	1.95	7	21	10	9	34	24	72	16	58	32	9	0.18
402200250180	2.6	8	21	10	9	34	24	72	16	58	32	9	0.18
402200400180	4	10	21	13	12	40	31	84	19	67	42	11	0.28
402200670180	6.8	13	28	16	15	51	40	109	23	90	54	14	0.64
402201000180	10.3	16	35	20	19	64	48	135	27	110	68	17	1.21