

Shortening Clutch Green Pin® GC

Product information



The shortening clutch is an essential part of chain slings, used to shorten the length of a chain leg and prevents instability of the load. The clutch compared to the shortening hook makes a straight pull possible. The Green Pin® Shortening Clutch is available in a range to suit 6 mm up to 18/20 mm grade 8 chain.

Certification on request: 2.1, 2.2, 3.1, MTCa, MPIb

... [Read more](#)

Material: Alloy Steel

Marking: According to standard

Temperature range: -40°C up to +200°C

Finish: painted white

Standard: EN 1677-1

Safety factor: 4:1

Grade: 8

Shortening Clutch Green Pin® GC

Blueprint

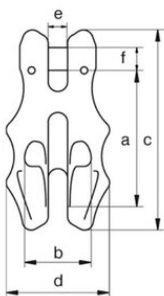

Technical data

Part code	Chain diameter mm	WLL ton	a mm	b mm	c mm	d mm	e mm	f mm	Weight kg
401300111020	6	1.12	52	23	75	42	7	8	0.23
401300201020	7-8	2	67	30	94	50	9	9	0.44
401300321020	10	3.2	83	38	116	63	11	13	0.87
401300541020	13	5.4	104	49	149	79	14	16	1.76
401300821020	16	8.2	127	60	184	99	18	20	3.2
401301281020	18-20	12.8	154	75	215	124	22	24	5.78