

Clevis Foundry Hook Pewag KFW

Product information



KFW clevis foundry hook for direct chain connection. For applications where jaw size "g" of the KHSW hook is inadequate, mainly foundries. Before using the hook, check whether hooks without safety catch are allowed to be used for this particular application.

... [Read more](#)

Material: High duty grade 10.

Marking: According to standard, CE-marked, Pewag or PW, winner or 10, H16, batch code and type.

Temperature range: -40°C up to +380°C.

Finish: Orange powder coated.

Standard: EN 1677-1

Safety factor: 4:1

Grade: 10

Clevis Foundry Hook Pewag KFW

Blueprint

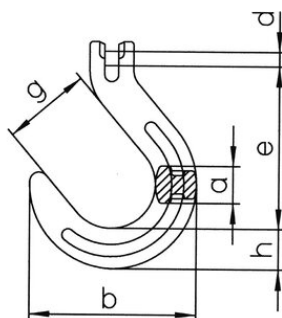

Technical data

Part code	Code	WLL ton	EWL	a mm	b mm mm	d mm mm	e mm mm	g mm mm	h mm mm	Weight kg
402300190540	KFW 7	1.9	121	25	118	9	121	64	29	1.02
402300250540	KFW 8	2.5	120	25	118	10	120	64	29	1.04
402300400540	KFW 10	4	140	32	143	12.5	140	76	35	1.74
402300670540	KFW 13	6.7	170	40	170	16	170	89	42	3.38