

## Clevis Grab Hook Pewag KPW

---

### Product information



KPW Clevis grab hooks are designed for the mounting of chain slings. For shortening and for slings that must not tighten. Reduction of load capacity not required thanks to 4-fold safety.

... [Read more](#)

---

**Material:** High duty grade 10.

**Marking:** According to standard, CE-marked, Pewag or PW, winner or 10, H16, batch code and type.

**Temperature range:** -40°C up to +380°C.

**Finish:** Orange powder coated.

**Standard:** EN 1677-1

**Safety factor:** 4:1

**Grade:** 10

## Clevis Grab Hook Pewag KPW

### Blueprint

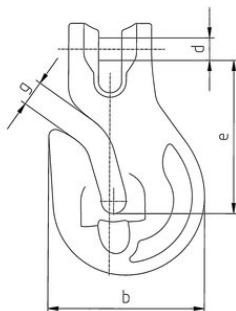

### Technical data

Part code	Code	WLL ton	EWL	b mm mm	dmm mm	e mm mm	g mm mm	Weight kg
402300140500	KPW 6	1.4	47	44	7	47	7	0.19
402300190500	KPW 7	1.9	63	57	9	63	9	0.46
402300250500	KPW 8	2.5	63	57	10	63	9	0.46
402300400500	KPW 10	4	78	71	12	78	12	0.9
402300670500	KPW 13	6.7	93	92	16	93	15	1.85
402301000500	KPW 16	10	115	113	20	115	19	3.49
402301600500	KPW 19/20	16	141	150	24	141	25	6.88
402301900500	KPW 22	19	158	165	27	158	27	9.68

KPW 19/20 and KPW 22 is without saddle