

## GN H10S Super Bow Shackle- Safety Pin

---

### Product information

We deliver a quality GN H10S Super Bow Shackle with Safety Pin in forged alloy steel.

... [Read more](#)

---

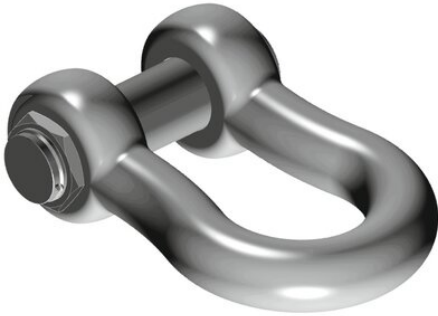

**Material:** Forged alloy steel quenched and tempered.

**Marking:** According to standard

**Temperature range:** -20°C up to 200°C (Up to WLL 55 ton) -40°C up to 200°C (Above WLL 55 ton)

**Finish:** Painted / Galvanized.

**Standard:** EN 10204

**Safety factor:** 5:1

## GN H10S Super Bow Shackle- Safety Pin

### Blueprint

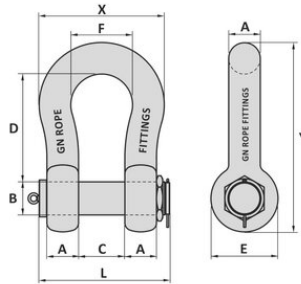

### Technical data

Part code	WLL ton	A mm	B mm	C mm	D mm	E mm	F mm	L mm	X mm	Y mm	Weight kg
420103000340	30	38	42	60	146	88	99	202	175	249	8.4
420104000340	40	45	50	74	178	103	126	249	216	300	15
420105500340	55	57	57	83	197	117	138	286	252	341	22
420108500340	85	70	70	105	260	143	180	344	320	437	42
420112000340	120	80	83	127	329	162	190	372	350	532	70
420115000340	150	90	95	135	380	200	240	405	420	613	110
420117500340	175	102	108	140	400	230	250	440	450	669	150
420120000340	200	120	121	180	500	260	290	525	530	811	225
420125000340	250	125	127	220	520	260	325	575	575	839	300
420130000340	300	135	152	220	500	305	330	605	610	869	352
420140000340	400	165	178	220	572	350	330	655	655	1,001	537